



**2017
POCKET GUIDE**

AUGUST 14 - 17, 2017

RENAISSANCE WOODBRIDGE HOTEL

ISELIN, NJ

#NMFPW2017

NMFPW 2017 WORKSHOP TEAM

August 14-17, 2017, Iselin, NJ

Workshop Team

Deborah Mills, CFM
 Larry Buss, PE, D.WRE, CFM
 Iain Hyde, CFM
 Tom Little, CGP, CFM
 Bill Nechamen, CFM
 Manny Perotin, PE, CFM
 George Riedel, CFM

Workshop Direction Team

Jenny Seffrood, *Event Planner*
 Anita Larson, *Certification Coordinator & Registration*

ASFPM Staff

Chad Berginnis, CFM <i>Executive Director</i>	Ingrid Wadsworth, CFM <i>Deputy Director Ops.</i>	Larry Larson, PE, CFM <i>Sr. Policy Advisor</i>
Jim Dunham <i>Member Services Coordinator</i>	Nancy Dunham <i>Certification Program Assistant</i>	Kait Laufenberg, CFM <i>Training & Chapter Coordinator</i>
Suzanne Gillingham <i>Financial Manager</i>	Michele Mihalovich <i>Public Information Officer</i>	Jason Schneeberger <i>IT Manager</i>

ASFPM Flood Science Center

Bill Brown, PE, <i>Center Director</i>	Jeff Stone, GISP, CFM <i>Senior Project Manager</i>
Bridget Faust <i>Project Research Specialist</i>	Robyn Wiseman, CFM <i>Research Scientist</i>
Jason Hochschild <i>GIS & Research Analyst</i>	Melissa Haig, MLIS <i>Research Librarian</i>
Alan Lulloff, PE, CFM, <i>Chief Scientist</i>	

ASFPM Executive Office
 575 D'Onofrio Drive, Suite 200, Madison, WI 53719
 608-828-3000, Fax: 828-6319 | www.floods.org

i Workshop Team
 1 Table of Contents
 2 Welcome and General Information
 3 Meeting Room Assignments

Sponsors

4 Our Sponsors

Exhibitors

5 Our Exhibitors

Program

6 Monday
 8 Tuesday
 16 Wednesday
 18 Thursday
 Center Spread (pg. 10-11) Meeting Rooms Floor Plan

Carry a smart phone or tablet?

Check out the mobile version of
 the NMFPW program at:
<http://bit.ly/2vxhyLm>

WELCOME!

Welcome to ASFPM's 7th National Mitigation and FloodProofing Workshop! We're glad you could join us. This Pocket Guide will help you locate scheduled program events and locations, so be sure to keep it close at hand. **YOUR NAME BADGE IS REQUIRED TO GET YOU INTO EVERYTHING YOU REGISTERED TO ATTEND AND YOU MUST WEAR IT ALL EVENTS IN ORDER TO BE ADMITTED.** If you have questions, see ASFPM staff at the registration desk.

Registration Desk *In front of Diamond A*

The registration desk will be open to serve you from 9:00 AM-5:00 PM Monday, 8:00 AM-5:00 PM Tuesday, 7:30 AM-9:30 AM Wednesday and 8:00 AM-4:00 PM Thursday.

CONCURRENT TRACKS

Disaster Recovery & Mitigation
Non-Structural Floodproofing
Resiliency
Project Best Practices
Enhanced Floodplain Management
Technical Training/Mini-workshops

MONDAY, AUGUST 14, 2017

9:00 AM-5:00 PM Registration Opens
1:30- 5:30 PM Workshops
5:30-7:30 PM Exhibitor & Sponsor Reception

TUESDAY, AUGUST 15, 2017

8:00 AM-5:00 PM Registration Open
8:00-9:00 AM Break
9:00-10:00 AM Opening Plenary
10:00-10:30 AM Break & Idea Exchange
10:30 AM- NOON Concurrent Session A
NOON-1:30 PM Keynote Luncheon
1:30-3:00 PM Concurrent Session B
1:30-5:00 PM Workshop
3:00-3:30 PM Break & Idea Exchange
3:30-5:00 PM Concurrent Session C
5:00-7:30 PM Exhibitors Social & Cracker Barrel

WEDNESDAY, AUGUST 16, 2017

7:30-9:30 AM Registration Open
7:30-8:30 AM Break
8:30-9:15 AM Plenary Two
9:30 AM-5:30 PM Field Tours

THURSDAY, AUGUST 17, 2017

8:00 AM-4:00 PM Registration Open
8:00-9:00 AM Break
9:00-10:00 AM Plenary Three
10:00-10:30 AM Break & Idea Exchange
10:30 AM- NOON Concurrent Session D
NOON-1:30 PM Keynote Luncheon
1:30-3:00 PM Concurrent Session E
3:00-3:30 PM Final Break & Idea Exchange

Our Sponsors

Diamond



FEMA

Platinum



ILC DOVER
creating what's next

Gold



Dewberry

Silver



Member of the FM Global Group

Bronze



PS Flood Barriers
Solutions That Hold Water



Our Exhibitors

Exhibitors

AquaFence

ASFPM

Coastal States Organization

Dewberry

FEMA Building Sciences

FM Approvals

Flood Break Automatic Floodgates

New Jersey Association for Floodplain Mgmt.

New York State Floodplain & Stormwater
Managers Association

Orange Flood Control, LLC

PS Flood Barriers

SmartVent + ILC Dover

Tetra Tech, Inc.

Texas Target Communities

Turnkey Contractor Solutions, LLC

Union of Concerned Scientists

Monday, August 14

9:00 - 5:00	Registration Open				
1:30 - 5:30	WORKSHOPS				
	<p>Flood Risk Management with Non-structural Floodproofing Techniques</p> <p>Diamond A</p> <p><i>Lea Adams, PE, Brian Rast, PE, PMP, CFM, USACE</i></p>	<p>No Adverse Impact Tools for Floodplain Managers & Engineers</p> <p>Sapphire A</p>		<p>Dry Floodproofing Considerations for Completing the FEMA Floodproofing Certificate</p> <p>Sapphire B</p> <p><i>John Squerciati, PE, CFM, Dewberry</i></p>	
5:30 - 7:30	Exhibitor & Sponsor Reception				

8:00 - 5:00	Registration Open			
8:00 - 9:00	Break - Exhibit Area			
9:00 - 10:00	Opening Plenary Diamond A&B			Remarks by the FEMA Flood Insurance Advocate - 2016 in Review. <i>Dave Stearrett, CFM, FEMA</i>
10:00 - 10:30	BREAK & Idea Exchange - Exhibit Area			
10:30 - Noon	CONCURRENT SESSION A			
	Disaster Recovery & Mitigation Diamond C	Floodproofing - Medical Facility Case Study Diamond D		Resiliency - Whole Community Sapphire A
	<p>1. NC Resiliency. <i>Bel Marquez, PE, PMP, CFM, Nathan Slauter, AICP, CFM, ESP Associates</i></p> <p>2. Flood Damage-Resistant Materials: Reducing Damage Related to Flood Events. <i>Juan Nieves, EIT, CFM, Dewberry</i></p> <p>3. New Jersey State Hazard Mitigation Plan Updates: Losses Avoided, Innovations and Partnerships. <i>Craig Wenger, CFM, Michael Baker International</i></p>	<p>1. NYU Langone Medical Center: Owner's Perspective. <i>Louis Wetstein, PE, NYU Langone Medical Center</i></p> <p>2. NYU Langone Medical Center: Challenges & Solutions. <i>Amy Macdonald, Thornton & Tomasetti</i></p> <p>3. NYU Langone Medical Center: Defining Flood Loads. <i>Chris Jones, PE</i></p>		<p>1. Post-flood Restoration and Protection of Rivers, Corridors and Floodplains. <i>Mike Klein, Vermont DEC Rivers Program</i></p> <p>2. Flood Economics: How flood mitigation investment returns positive benefits. <i>Leo Abruzzese, The Economic Intelligence Unit</i></p> <p>3. Developing Resilient Multifamily Housing Communities- Reading Multifamily Infrastructure, Operations and People to be Ready to Respond. <i>Laurie Schoeman, Enterprise Community Partners</i></p>
				Mini-workshop - Historic Home Mitigation Sapphire B
				<p>Historic Home Mitigation and Turn Key Elevation Operations. <i>Rod Scott, CFM, L&R Resources, LLC, Steven Hauck, SJ Hauck House Movers</i></p>

Venue Map

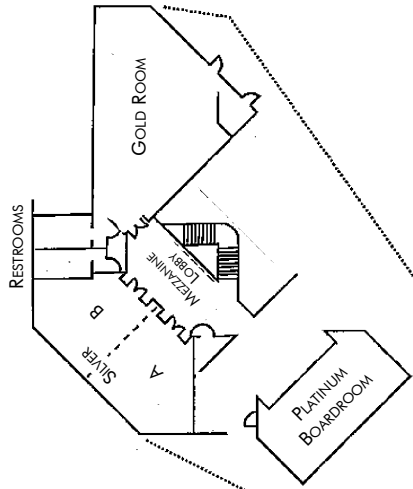

**MEZZANINE
LEVEL**

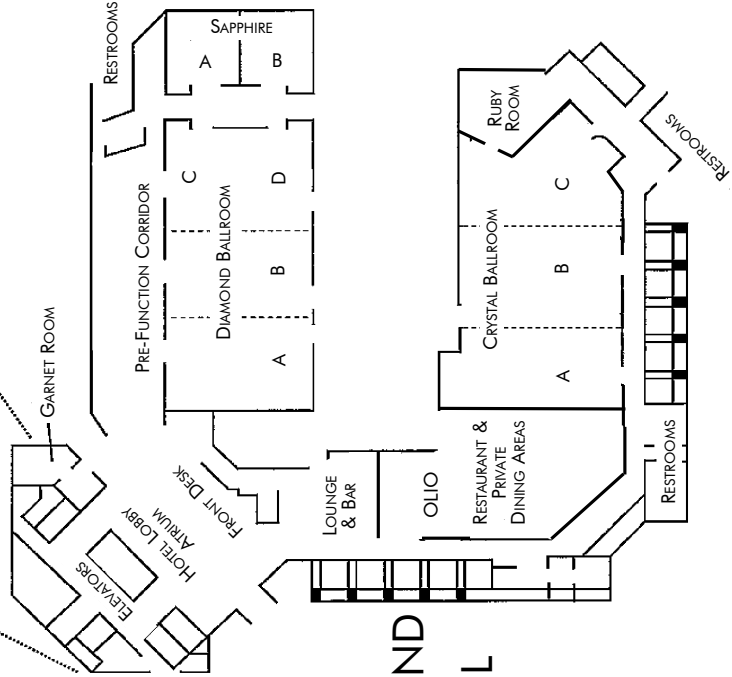

**GROUND
LEVEL**

Noon - 1:30	Keynote Luncheon Diamond A&B			Resilient Bridgeport: Linking Community Action, Infrastructure and Policy. <i>David Kooris, AICP, State of CT</i>	
1:30 - 3:00	CONCURRENT SESSION B				
	Disaster Recovery & Mitigation Best Practices Diamond C	Non-structural Floodproofing: Urban Floodproofing Best Practices Diamond D		Non-structural Floodproofing: Best Practices Sapphire A	Mini-workshop - FFRMS Sapphire B
	1. Alternatives to Traditional Structural Mitigation. <i>John Squerciati, PE, CFM, Dewberry</i> 2. Floodplain Management in Multi-family Housing. <i>Manny Perotin, PE, CFM, CDM Smith</i> 3. Use of Flood Vents in Multi-family Buildings. <i>Clark Brewer, FEMA RII</i>	1. Nonstructural Floodproofing in Historically Significant Areas. <i>Marco Ciarla, Andrew Felter, PE, USACE</i> 2. New York City's Residential Build-it-Back Program. <i>Sydney Delmar, Dewberry</i> 3. APA Sub-division Design. <i>Chad Bergin-nis, CFM, ASFPM</i>		1. Avoiding the School of Hard Knocks. <i>Dan Bass, CFM; John Ingargiola, CFM, FEMA</i> 2. Sandy MAT Recommendations. <i>Dan Bass, CFM; John Ingargiola, CFM, FEMA</i>	Flood Reduction Standards & the National Mitigation Investment Strategy. <i>Rachel Sears, Andrew Martin, FEMA</i>
1:30 - 5:00	WORKSHOP: FEMA P-348 Protecting Building Utilities from Flood Damage. Crystal A		<i>John Squerciati, PE, CFM, Deborah Mills, CFM, Dewberry on behalf of FEMA Building Sciences</i>		
3:00 - 3:30	BREAK & Idea Exchange - Exhibit Area				

3:30 - 5:00	CONCURRENT SESSION C				
	Disaster Recovery & Mitigation - Residential Best Practices Diamond C	Funding Mechanisms - Best Practices Diamond D		Resiliency - Resilience Scorecard Sapphire A	Mini-workshop - Floodproofing Sapphire B
	<p>1. Town of Union Beach Residential Elevations. <i>Bob Burtlew, Borough of Union Beach, NJ</i></p> <p>2. New Jersey Super Storm Sandy Recovery & Mitigation - Lessons Learned. <i>Jillian Stokey, NJSP, Office of Emergency Management</i></p>	<p>1. Direct to Homeowner Floodproofing Grants - retroFIT Program Charlotte-Mecklenburg County, NC. <i>David Love, PE, CFM, Tim Trautman, PE, CFM, Charlotte-Mecklenburg Stormwater Svcs., NC</i></p> <p>2. Financing Floodproofing: Using FHA's 203K loan program. <i>Chad Berginnis, CFM, ASFPM; Tony Mercantate, PP, AICP, Middletown, NJ</i></p>		<p>1. How to Spatially Evaluate Networks of Plans to Reduce Hazard Vulnerability. <i>Jaimie Masterson, Texas Target Communities</i></p> <p>2. Community flood resilience measurement framework and tool. <i>Jeffrey Czajkowski, PhD, Wharton School, University of Pennsylvania</i></p>	<p>Floodproofing for New Construction: What Should be Allowed? <i>Bill Coulbourne, PE, AECOM, Chris Jones, PE</i></p>
5:00 - 7:30	Exhibitors Social & Cracker Barrel Diamond A&B				

Wednesday, August 16

8:30 - 9:15	Plenary Two Diamond A&B		Post-Sandy Recovery and a Resilient Future <i>David Kutner, NJ Future</i>	
9:15 - 9:30	Instructions for Field Tours & Bus Loading <i>Jenny Seffrood, ASFPM</i>			
9:30 - 5:30	Field Tours			
	Lower Hudson	Staten Island		Union Beach, NJ

9:00 - 10:00	Plenary Three Diamond A&B		USACE Contributions to Flood Risk Management and Resilience. <i>Stephanie Bray, PhD, CFM, USACE</i>		
10:00 - 10:30	BREAK & Ideas Exchange				
10:30 - NOON	CONCURRENT SESSION D				
	Project Best Practices: Benefits Diamond C	Enhanced Flood-plain Mgmt. - Higher Standards Diamond D		Resiliency: Coastal Communities Sapphire A	FEMA HMA Grant Best Practices and FY 2017 Sapphire B
	1. Old River Landing, LA Amphibious Houses - Four Decades Afloat. <i>Elizabeth English, PhD, Univ. of Waterloo</i> 2. Cost-Effectiveness for FEMA HMA Programs: BCA, Pre-Calculated Benefits, and other Methodologies. <i>Chris Mewes, CFM, Resilience Strategies</i> 3. Communication Lessons Learned to Motivate Audiences per Flood Risk Communication. <i>Rachel Hogan, Nurture Nature</i>	1. Emergency Power for Critical Facilities. <i>David Low, PE, DK Low & Associates</i> 2. Mitigating Structural Damage with Engineered Flood Vents. <i>Tom Little, CFM, SmartVent, Inc.; Nick Agnoli, PE, Federal Energy Regulatory Commission.</i>		1. Norfolk: Building the Coastal Community of the Future. <i>George Homewood, FAICP, CFM, City of Norfolk</i> 2. New Sea Level Rise Inundation Study on US Communities & Adaptation Tool Demo. <i>Shana Udvardy, Union of Concerned Scientists</i> 3. Design of a Green/Grey Shoreline Protection Approach in San Diego. <i>Brian Leslie, Moffatt & Nichol</i>	FEMA's 2017 FMA and PDM Grants: Opportunities, Tips and Tricks. <i>Kayed Lakhia, PE, CFM, FEMA; Manny Perotin, Eric Kenney, CDM Smith</i>
NOON - 1:30	Keynote Luncheon Diamond A&B	<i>Katherine Greig, NYC Mayer's Office of Resiliency & Recovery</i>			

1:30 - 3:00	CONCURRENT SESSION E				
	<p>New York City Best Practices</p> <p>Diamond C</p>	<p>Enhanced Floodproofing Best Practices</p> <p>Diamond D</p>		<p>Mini-workshop - Public Assistance 406 Mitigation Innovations</p> <p>Sapphire A</p>	<p>Mini-workshop - Floodproofing & Mitigation Option</p> <p>Sapphire B</p>
	<p>1. Resilient by Design: Post-Sandy Design Guidelines and Practice at PANYNJ. <i>Joshua De Florio, ACIP</i></p> <p>2. Resilient Land Use Planning: New York City's Approach. <i>Trevor Johnson, NYC DCP</i></p>	<p>1. Successes During the 2016 Iowa Flooding: Lessons Learned from the 2008 Midwest. <i>Dan Bass, FEMA</i></p> <p>2: Development & Implementation of Dry Floodproofing Stored at the Point of Use. <i>Jeffrey Roushey, PE, CFM, ILC Dover</i></p>		<p>Hazard Mitigation in the Public Assistance Program Following Hurricane Sandy. <i>Boris Yundelson, FEMA RII; Manny Perotin, PE, CFM, CDM Smith</i></p>	<p>The importance of flood mitigation strategy to the Fortune 500 type of companies. <i>Stuart Ullsh, FM Global; Charlie Mahall, FM Approvals</i></p>
3:00 - 3:30	Final Break & Ideas Exchange				
	<p>Thank you for attending FloodProofing</p> <p>the National Mitigation & Workshop!</p>				



**ASSOCIATION OF STATE
FLOODPLAIN MANAGERS, INC.**

575 D'ONOFRIO DR., STE. 200

MADISON, WI 53719

608-828-3000 | ASFP@FLOODS.ORG

WWW.FLOODS.ORG